LICENSING SUB-COMMITTEE A

TUESDAY, 4TH JULY, 2006 at 19:00 HRS - CIVIC CENTRE, HIGH ROAD, WOOD GREEN, LONDON, N22.

MEMBERS: Councillors Demirci, Patel and Vanier

AGENDA

1. APOLOGIES FOR ABSENCE

2. URGENT BUSINESS:

The Chair will consider the admission of any late items of urgent business. (Late items will be considered under the agenda item where they appear. New items will be dealt with at item 8 below).

3. DECLARATIONS OF INTEREST:

A member with a personal interest in a matter who attends a meeting of the Authority at which the matter is considered must disclose to that meeting the existence and nature of that interest at the commencement of that consideration, or when the interest becomes apparent.

A member with a personal interest in a matter also has a prejudicial interest in that matter if the interest is one which a member of the public with knowledge of the relevant facts would reasonably regard as so significant that it is likely to prejudice the member's judgement of the public interest.

4. SUMMARY OF PROCEDURE: (PAGES 1 - 4)

The Chair will explain the procedure that the Committee will follow for each of the hearings considered under the Licensing Act 2003. A copy of the procedure is attached.

5. MINUTES: (PAGES 5 - 8)

To approve the minutes of the previous meeting of the Licensing Sub-Committee A held on 13 June 2006 (attached).

6. THE MAGIC FLUTE, 31 HIGH STREET, N8 (HORNSEY WARD): (PAGES 9 - 32)

To consider an application to provide a licensable activity in the form of Supply of Alcohol, Provision of Regulated Entertainment and Provision of Late Night Refreshment.

7. YAYLA RESTAURANT, 429 GREEN LANES, N4 (SEVEN SISTERS WARD): (PAGES 33 - 66)

To consider an application to vary a New Premises License.

8. ITEMS OF URGENT BUSINESS:

To consider any new items admitted under item 2 above.

YUNIEA SEMAMBO
Head of Member Services
5th Floor
River Park House
225 High Road
Wood Green
London N22 8HQ

NICOLAS MATTIS
Principal Support Officer (Council)
Tel: 020 8489 2916
Fax: 020 8489 2660
nicolas.mattis@haringey.gov.uk

26 JUNE 2006

<p><u>LICENSING SUB-COMMITTEE HEARINGS</u> <u>PROCEDURE SUMMARY</u></p>	<p>Tick box to record action / decisi on</p>
<p><u>INTRODUCTION</u></p>	
<p>1. The Chair introduces himself and invites other Members, Council officers, Police, Applicant and Objectors to do the same.</p>	
<p>2. The Chair invites Members to disclose any prior contacts (before the hearing) with the parties or representations received by them</p>	
<p>3. The Chair explains the procedure to be followed by reference to this summary which will be distributed.</p>	
<p><u>NON-ATTENDANCE BY PARTY OR PARTIES</u></p>	
<p>4. If one or both of the parties fails to attend, the Chair decides whether to:</p>	
<p>(i) grant an adjournment to another date, or</p>	
<p>(ii) proceed in the absence of the non-attending party.</p>	
<p>Normally, an absent party will be given one further chance to attend.</p>	
<p><u>TOPIC HEADINGS</u></p>	
<p>5. The Chair suggests the "topic headings" for the hearing.</p> <p>In the case of the majority of applications for variation of hours, or other terms and conditions, the main topic is:</p> <p>Whether the extensions of hours etc. applied for would conflict with the four licensing objectives i.e.</p>	
<p>(i) the prevention of crime and disorder,</p>	
<p>(ii) public safety,</p>	

(iii) the prevention of public nuisance, and	
(iv) the protection of children from harm.	
6. The Chair invites comments from the parties on the suggested topic headings and decides whether to confirm or vary them.	
<u>WITNESSES</u>	
7. The Chair asks whether there are any requests by a party to call a witness and decides any such request.	
8. <u>Only</u> if a witness is to be called, the Chair then asks if there is a request by an opposing party to “cross-examine” the witness. The Chair then decides any such request.	
<u>DOCUMENTARY EVIDENCE</u>	
9. The Chair asks whether there are any requests by any party to introduce late documentary evidence.	
10. If so, the Chair will ask the other party if they object to the admission of the late documents.	
11. If the other party <u>do object</u> to late admission, the following criteria shall be taken into account when the Chair decides whether or not to admit the late documents:	
(i) What is the reason for the documents being late?	
(ii) Will the other party be unfairly taken by surprise by the late documents?	
(iii) Will the party seeking to admit late documents be put at a major disadvantage if admission of the documents is refused?	
(iv) Is the late evidence really important?	
(v) Would it be better and fairer to adjourn to a later date?	
<u>THE LICENSING OFFICER'S INTRODUCTION</u>	
12. The Licensing Officer introduces the report explaining, for example, the existing hours, the hours applied for and	

<p>the comments of the other Council Services or outside official bodies. This should be as “neutral” as possible between the parties.</p>	
<p>13. The Licensing Officer can be questioned by Members and then by the parties.</p>	
<p><u>THE HEARING</u></p>	
<p>14. This takes the form of a discussion led by the Chair. The Chair can vary the order as appropriate but it should include:</p>	
<p>(i) an introduction by the Objectors' main representative</p>	
<p>(ii) an introduction by the Applicant or representative</p>	
<p>(iii) questions put by Members to the Objectors</p>	
<p>(iv) questions put by Members to the Applicant</p>	
<p>(v) questions put by the Objectors to the Applicant</p>	
<p>(vi) questions put by the Applicant to the Objectors</p>	
<p><u>CLOSING ADRESSES</u></p>	
<p>15. The Chair asks each party how much time is needed for their closing address, if they need to make one.</p>	
<p>16. Generally, the Objectors make their closing address before the Applicant who has the right to the final closing address.</p>	
<p><u>THE DECISION</u></p>	
<p>17. Members retire with the Committee Clerk and legal representative</p>	

<p>to consider their decision including the imposition of conditions.</p> <p>The decision is put in writing and Members return to the meeting.</p>	
<p>18. The Chair should read out the following statement before asking the Committee Clerk to read out in public a summary of the Committee's Decision:</p> <p><i>“The Committee Clerk will read out a summary of the Committee’s Decision. The Parties will receive a written Decision Notice in which the Decision will be formally set out. Please note that the written Decision will be substantially the same although the wording might vary slightly from the summary read out.”</i></p>	

MINUTES OF THE LICENSING SUB-COMMITTEE A (2003 LICENSING ACT)
13 June 2006

Councillors Demirci*, Patel (Chair)*, Vanier*

* denotes members present

LCA01 APOLOGIES FOR ABSENCE (Agenda Item 1)

None received.

LCA02 URGENT BUSINESS (Agenda Item 2)

No items of urgent business were received.

LCA03 DECLARATIONS OF INTEREST (Agenda Item 3)

No declarations of interest were received.

LCA04 CAIPIRINHA, 177 Archway Road N6 (Highgate ward) (Agenda Item 5):

.....

RESOLVED:

The Committee decided to grant the application in full and subject to the following conditions:

- (i) Conditions to enforce the operating schedule.
- (ii) Conditions to enforce the Standard Mandatory Condition set out at Sections 19 and 21 of the Licensing Act 2006.
- (iii) Adhere to the conditions set out by the CPA on under-age drinking.
- (iv) The applicant shall commission an independent experts report (the expert to be agreed with the Environmental Health Department of Haringey Council) which will address any smells emanating from the premises and implement any recommendations to ensure that smells are properly vented from the premises to prevent any nuisance.
- (v) The applicant shall commission an independent experts report (the expert to be agreed with the Environmental Health Department of Haringey Council) which will address any noise or vibration emanating from the premises, and implement any recommendations to ensure that noise and vibration emanating from the premises (including from the extractor fan) does not cause a nuisance.

INFORMATIVE:

- (i) This licence does not constitute a consent under any other regime. It is necessary for the licensee to obtain any other

**MINUTES OF THE LICENSING SUB-COMMITTEE A (2003 LICENSING ACT)
13 June 2006**

- consents that may be necessary for the lawful operation of the premises, including planning consent.
- (ii) All parties were reminded that under the Licensing Act 2003, a review of the license can be applied for at any time by interested parties and responsible authorities.

**LCA05 THE NEXUS POINT RESTAURANT, 686 High Road N17 (West Green ward)
(Agenda Item 6):**

RESOLVED:

The Committee decided to grant the application in part, subject to the following conditions:

- (i) Conditions to enforce the operating schedule.
- (ii) Conditions to enforce the Standard Mandatory Condition set out at Sections 19 and 21 of the Licensing Act 2006.
- (iii) The licensee must provide a door supervisor at the premises when a private function is held at the premises for the duration of the function.
- (iv) That the opening hours for public are:
Sundays to Thursdays 11:00 to 03:00
Fridays and Saturdays 11:00 to 04:00
- (v) That hours for provision of late night refreshments are:
Sundays to Thursdays 23:00 to 02:30
Fridays and Saturdays 23:00 to 03:30
- (vi) That hours for supply of alcohol are:
Sundays to Thursdays 11:00 to 02:30
Fridays and Saturdays 11:00 to 03:30
- (vii) That hours for recorded music are:
Sundays to Thursday 23:00 to 03:00
Friday and Saturdays 23:00 to 04:00

These hours had been requested by the applicant and in accordance with the applicant's letter of 30 March 2006, the hours were adjusted to allow for the licensable activity to end 30 minutes before closing of the premises.

The reason why the requested change of days in relation to the supply of alcohol had not been permitted was because permission for these days would not have been able to comply with premises opening hours.

- (viii) Adhere to the conditions set out by the CPA on under-age drinking, namely that alcohol may only be sold to individuals over the age of 18 with valid proof of identification with one of the following:

**MINUTES OF THE LICENSING SUB-COMMITTEE A (2003 LICENSING ACT)
13 June 2006**

- a valid passport
- a photo driving license issued in an EU country
- a proof of age standard card system
- a citizen card, supported by the Home Office

REASONS:

The reasons for applying these conditions are to protect children from harm, promote public safety, and prevention of public nuisance.

INFORMATIVE:

- (i) There is no permission for the provision of facilities for dancing. If the applicant wishes to provide this, an application for a variation to the license would need to be made.
- (ii) This licence does not constitute a consent under any other regime. It is necessary for the licensee to obtain any other consents that may be necessary for the lawful operation of the premises, including planning consent.

LCA06 ISTANBUL RESTAURANT, 441 Green Lanes N4 (Harringay ward)(Agenda Item 8):

This Item was adjourned at the agreement of the Committee, the applicant, interested parties and responsible authorities due to time constraints which the Committee was under to hear all application of the evening. The application would be brought back before a future Licensing Sub-committee.

LCA07 ATHENA PALACE, 657 Green Lanes N8 (Harringay ward)(Agenda Item 7):

After a short hearing comprising a the Licensing Officer's Report and the first part of an objector's case, the proceedings were interrupted by the Legal Representative. It had been brought to the Committee's attention, that the premises license applied for would affect 500 or more people. Under the Council's Constitution (Part E.7 Section 6 (1)(e)) it is the full Licensing Committee only that can exercise the functions of the Licensing Sub-Committees in relation to any premises, site or event where 500 or more persona are to be present.

The hearing was subsequently adjourned, to be brought back to a meeting of the full Licensing Committee, once the actual number of people to be present at the premises was properly confirmed. The Licensing Officer confirmed that a fee would not be levied to the applicant for a new application, but that fresh papers would need to be submitted. These would then be fully circulated to all interested parties and responsible authorities.

LCA08 ITEMS OF URGENT BUSINESS (Agenda Item 9)

None

**MINUTES OF THE LICENSING SUB-COMMITTEE A (2003 LICENSING ACT)
13 June 2006**

The meeting ended at 22:30

.....
Councillor JAYANTI PATEL
Chair of Licensing Sub-Committee A 2006/7

Date.....

Licensing Act 2003 Sub-Committee on 4th JULY 2006

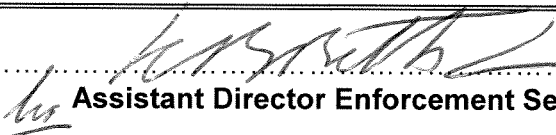
Report title: Application for a Premises Licence THE MAGIC FLUTE, 31 HIGH STREET, LONDON, N8 7QB	
Report of: The Lead Officer Licensing	
Ward(s) affected	HORNSEY
1. Purpose To consider an application by SOPGHIA HADJI-MICHAEL. THE MAGIC FLUTE. to provide a licensable activity in the form of the sale of Alcohol, Late Night Refreshment and Regulated Entertainment	
2. Recommendations 2.1 <ul style="list-style-type: none"> (a) Grant the application as asked (b) Modify the conditions of the licence, by altering or omitting or adding to them (c) Reject the whole or part of the application <p>The Committee is asked to note that it may not modify the conditions or reject the whole or part of the application unless it is necessary to promote the licensing objectives.</p>	
Report authorised by: Robin Payne.....  Assistant Director Enforcement Services	
Contact Officer: Ms Daliah Barrett	Telephone: 020 8489 5103
3. Executive summary For consideration by Sub Committee under Licensing Act 2003 for a Premises Licence.	
4. Access to information: Local Government (Access to Information) Act 1985 Background Papers The following Background Papers are used in the preparation of this Report: File: THE MAGIC FLUTE The Background Papers are located at Enforcement Service, Civic Centre, High Road Wood Green N22	

5. REPORT

Background

5.1 Application by **SOPHIA HADJI-MICHAEL** for a Premises Licence in respect of **THE MAGIC FLUTE, 31 HIGH STREET, HORNSEY, LONDON, N8 6QB** under the Licensing Act 2003.

5.2 Details for a new Premises Licence -APP 1

Opening Hours for Public

Sunday to Saturday 11.00 - 03.00

Sale of Alcohol for Consumption on the Premises

Sunday to Saturday 11.00 – 02.30

Provision of Regulated Entertainment

Live Music

Sunday to Saturday 11.00 – 02.30

Provision of Facilities for Making Music

Sunday to Saturday 11.00 – 02.30

Provision of Recorded Music

Sunday to Saturday 11.00 – 02.30

Performances of Dance

Sunday to Saturday 11.00 - 02.30

Provision of Facilities for Making Music

Sunday to Saturday 11.00 – 02.30

Provision of Facilities for Dancing

Sunday to Saturday 11.00 – 02.30

Late Night Refreshment

Sunday to Saturday 23.00 – 02.30

Designated Premises Supervisor:

SOPHIA HADJ-MICHAEL

5.3 Crime and Disorder

Entry will only be permitted to persons attending bona fide pre-booked functions.

Food will be available at all times

Alcohol will only be sold to customers seated at tables by waiter/waitress service.

5.4 Public Safety

Fire safety equipment will be checked regularly and any requirements made by the Fire Safety Officer will be complied with.

5.5 Public Nuisance

Signs will be displayed at the exit reminding customers to leave quietly and respect the neighbours.

Staff will call Taxis/Mini cabs to the premises for the use of customers leaving the premises when requested to do so.

5.6 Child Protection

All staff will be trained that alcohol will only be sold to persons who can produce photographic identification where there is any doubt that they are over the age of 18.

6. RELEVANT REPRESENTATIONS (CONSULTATION)

Responsible Authorities:

6.1 Comments of Metropolitan Police

The Police have no adverse comments to make regarding this application.

6.2 Comments of Enforcement Services:

Noise Team

Have no objections to this application.

Food Team

Have no objections to this application

Health and Safety

Have no objections to this application

Trading Standards

Have no objections to this application

6.3 Fire Officer - APP 2

There are items of concern to this authority as follows:-

LICENSING OBJECTIVE NOT ADEQUATELY ADDRESSED	LOCATION AND DETAIL OF MATTERS WHICH ARE CONSIDERED TO PUT PEOPLE AT RISK IN THE EVENT OF A FIRE EMERGENCY	STEPS CONSIDERED NECESSARY TO PROMOTE THE PUBLIC SAFETY LICENSING OBJECTIVE
Public Safety	Throughout premises	<ol style="list-style-type: none"> 1. Fire alarm to BS5839 Pt6 (Lights and Buzzers) 2. Emergency Lighting to BS5266 3. Appropriate fire extinguishers suitable for the risk 4. All signs to comply with BS5499
Public Safety	Throughout premises	<ol style="list-style-type: none"> 1. Written Fire Risk Assessment required 2. Evacuation plan required

6.5 Planning Officer –APP 3

Has made the following objection:

Reason for objection is based on the following condition of consent (HGY/1992/1362) granted on the 06.04.1992 for the retention of Ground Floor Front Room as hot food takeaway (A3).

The reason hereby permitted shall not be operated before 08.00 or after 18.00 on Mondays to Fridays and not at all on Saturdays, Sundays, or Bank Holidays.

Reason: this permission is given to facilitate the beneficial use of the premises whilst ensuring that the amenities of adjacent residential properties are not diminished.

6.6. Comments of Child Protection Agency or Nominee

Have no objections to this application.

7.0 Interested Parties

No objections have been received against this application.

8.0 Financial Comments

The fee which would be applicable for this application was **£190.00**

APP 1

APPLICATION FORM

A

Plays Standard days and timings (please read guidance note 6)			<u>Will the performance of a play take place indoors or outdoors or both – please tick</u> (please read guidance note 2)	Indoors	<input type="checkbox"/>
Day	Start	Finish		Outdoors	<input type="checkbox"/>
Mon			<u>Please give further details here</u> (please read guidance note 3)	Both	<input type="checkbox"/>
Tue					
Wed			<u>State any seasonal variations for performing plays</u> (please read guidance note 4)		
Thur					
Fri			<u>Non standard timings. Where you intend to use the premises for the performance of plays at different times to those listed in the column on the left, please list</u> (please read guidance note 5)		
Sat					
Sun					

C

Indoor sporting events Standard days and timings (please read guidance note 6)			<u>Please give further details</u> (please read guidance note 3)
Day	Start	Finish	
Mon			<u>State any seasonal variations for indoor sporting events</u> (please read guidance note 4)
Tue			
Wed			
Thur			<u>Non standard timings. Where you intend to use the premises for indoor sporting events at different times to those listed in the column on the left, please list</u> (please read guidance note 5)
Fri			
Sat			
Sun			

**Application for a premises licence to be granted
under the Licensing Act 2003**

PLEASE READ THE FOLLOWING INSTRUCTIONS FIRST

Before completing this form please read the guidance notes at the end of the form.
If you are completing this form by hand please write legibly in block capitals. In all cases ensure that your answers are inside the boxes and written in black ink. Use additional sheets if necessary.

You may wish to keep a copy of the completed form for your records.

I/We SOPHIA HADJI-MICHAEL

(Insert name(s) of applicant)

apply for a premises licence under section 17 of the Licensing Act 2003 for the premises described in Part 1 below (the premises) and I/we are making this application to you as the relevant licensing authority in accordance with section 12 of the Licensing Act 2003

Part 1 – Premises Details

Postal address of premises or, if none, ordnance survey map reference or description THE MAGIC FLUTE 31 HIGH STREET HORNSEY			
Post town	LONDON	Post code	N8 7QB

Telephone number at premises (if any)	0208 341 7120
Non-domestic rateable value of premises	£32500

Part 2 - Applicant Details

Please state whether you are applying for a premises licence as
Please tick yes

- a) an individual or individuals * please complete section (A)
- b) a person other than an individual *
- i. as a limited company please complete section (B)
- ii. as a partnership please complete section (B)
- iii. as an unincorporated association or please complete section (B)
- iv. other (for example a statutory corporation) please complete section (B)
- c) a recognised club please complete section (B)
- d) a charity please complete section (B)

Current postal address if different from premises address			
Post Town		Postcode	
Daytime contact telephone number			
E-mail address (optional)			

(B) OTHER APPLICANTS

Please provide name and registered address of applicant in full. Where appropriate please give any registered number. In the case of a partnership or other joint venture (other than a body corporate), please give the name and address of each party concerned.

Name
Address
Registered number (where applicable)
Description of applicant (for example, partnership, company, unincorporated association etc.)
Telephone number (if any)
E-mail address (optional)

Part 3 Operating Schedule

When do you want the premises licence to start?

Day		Month		Year			
1	9	0	6	2	0	0	6

If you wish the licence to be valid only for a limited period, when do you want it to end?

Day		Month		Year			

E

Live music Standard days and timings (please read guidance note 6)			<u>Will the performance of live music take place indoors or outdoors or both – please tick</u> (please read guidance note 2)	Indoors	<input checked="" type="checkbox"/>
				Outdoors	<input type="checkbox"/>
				Both	<input type="checkbox"/>
Day	Start	Finish	<u>Please give further details here</u> (please read guidance note 3) Amplified or unamplified music		
Mon	11.00	02.30			
Tue	11.00	02.30	<u>State any seasonal variations for the performance of live music</u> (please read guidance note 4)		
Wed	11.00	02.30			
Thur	11.00	02.30	<u>Non standard timings. Where you intend to use the premises for the performance of live music at different times to those listed in the column on the left, please list</u> (please read guidance note 5)		
Fri	11.00	02.30			
Sat	11.00	02.30			
Sun	11.00	02.30			

G

Performances of dance Standard days and timings (please read guidance note 6)			<u>Will the performance of dance take place indoors or outdoors or both – please tick</u> (please read guidance note 2)	Indoors	<input checked="" type="checkbox"/>
Day	Start	Finish		Outdoors	<input type="checkbox"/>
Mon	11.00	02.30	<u>Please give further details here</u> (please read guidance note 3) Occasional Cultural Dancing	Both	<input type="checkbox"/>
Tue	11.00	02.30			
Wed	11.00	02.30	<u>State any seasonal variations for the performance of dance</u> (please read guidance note 4)		
Thur	11.00	02.30			
Fri	11.00	02.30	<u>Non standard timings. Where you intend to use the premises for the performance of dance at different times to those listed in the column on the left, please list</u> (please read guidance note 5)		
Sat	11.00	02.30			
Sun	11.00	02.30			

Provision of facilities for making music Standard days and timings (please read guidance note 6)			<u>Please give a description of the facilities for making music you will be providing</u> Amplified or unamplified music		
			<u>Will the facilities for making music be indoors or outdoors or both – please tick</u> (please read guidance note 2)		Indoors
			Outdoors	<input type="checkbox"/>	
			Both	<input type="checkbox"/>	
Day	Start	Finish	<u>Please give further details here</u> (please read guidance note 3) Amplified or unamplified music Disco		
Mon	11.00	02.30			
Tue	11.00	02.30	<u>State any seasonal variations for the provision of facilities for making music</u> (please read guidance note 4)		
Wed	11.00	02.30			
Thur	11.00	02.30	<u>Non standard timings. Where you intend to use the premises for provision of facilities for making music at different times to those listed in the column on the left, please list</u> (please read guidance note 5)		
Fri	11.00	02.30			
Sat	11.00	02.30			
Sun	11.00	02.30			

K

Provision of facilities for entertainment of a similar description to that falling within i or j Standard days and timings (please read guidance note 6)			<u>Please give a description of the type of entertainment facility you will be providing</u>		
Day	Start	Finish	<u>Will the entertainment facility be indoors or outdoors or both – please tick</u> (please read guidance note 2)	Indoors	<input type="checkbox"/>
Mon				Outdoors	<input type="checkbox"/>
				Both	<input type="checkbox"/>
Tue			<u>Please give further details here</u> (please read guidance note 3)		
Wed					
Thur			<u>State any seasonal variations for the provision of facilities for entertainment of a similar description to that falling within i or j</u> (please read guidance note 4)		
Fri					
Sat			<u>Non standard timings. Where you intend to use the premises for the provision of facilities for entertainment of a similar description to that falling within i or j at different times to those listed in the column on the left, please list</u> (please read guidance note 5)		
Sun					

M

Supply of alcohol Standard days and timings (please read guidance note 6)			Will the supply of alcohol be for consumption (Please tick box) (please read guidance note 7)	On the premises	<input checked="" type="checkbox"/>
				Off the premises	<input type="checkbox"/>
				Both	<input type="checkbox"/>
Day	Start	Finish	State any seasonal variations for the supply of alcohol (please read guidance note 4)		
Mon	11.00	02.30			
Tue	11.00	02.30			
Wed	11.00	02.30			
Thur	11.00	02.30			
Fri	11.00	02.30			
Sat	11.00	02.30			
Sun	11.00	02.30			
			Non standard timings. Where you intend to use the premises for the supply of alcohol at different times to those listed in the column on the left, please list (please read guidance note 5)		

State the name and details of the individual whom you wish to specify on the licence as premises supervisor

Name SOPHIA HADJI-MICHAEL	
Address 109 SHIREHALL PARK HENDON LONDON	
Postcode	NW4 2QU
Personal Licence number (if known)	
Issuing licensing authority (if known) BARNET COUNCIL	

P Describe the steps you intend to take to promote the four licensing objectives:

a) General – all four licensing objectives (b,c,d,e) (please read guidance note 9)

See below

b) The prevention of crime and disorder

Entry will only be permitted to persons attending bona fide pre-booked functions.

Food will be available at all times.

Alcohol will only be sold to customers seated at tables by waiter / waitress service.

c) Public safety

Fire safety equipment will be checked regularly and any requirements made by the Fire Safety Officer will be complied with.

d) The prevention of public nuisance

Staff will call Taxis / Mini cabs for the use of customers leaving the premises when requested to do so.

Signs will be displayed at the exit reminding customers to leave quietly and respect the neighbours

e) The protection of children from harm

All staff will be trained that alcohol will only be sold to persons who can produce photographic identification where there is any doubt that they are over the age of 18.

Consent of individual to being specified as premises supervisor

I SOPHIA HADJI-MICHAEL
[full name of prospective premises supervisor]

of 109 SHIREHALL PARK
HENDON
LONDON
NW4 2QU

[home address of prospective premises supervisor]

hereby confirm that I give my consent to be specified as the designated premises supervisor in relation to the application for

PREMISES LICENCE
[type of application]

by

SOPHIA HADJI-MICHAEL
[name of applicant]

relating to a premises licence 1
[number of existing licence, if any]

for THE MAGIC FLUTE
31 HIGH STREET
HORNSEY
LONDON
N8 7QB

[name and address of premises to which the application relates]

and any premises licence to be granted or varied in respect of this application made by

SOPHIA HADJI-MICHAEL

[name of applicant]

concerning the supply of alcohol at

THE MAGIC FLUTE
31 HIGH STREET
HORNSEY
LONDON
N8 7QB

[name and address of premises to which application relates]

I also confirm that I am applying for, intend to apply for or currently hold a personal licence, details of which I set out below.

Personal licence number

[insert personal licence number, if any]

Personal licence issuing authority

BARNET COUNCIL, BUILDING 4 NORTH LONDON BUSINESS PARK,
[insert name and address and telephone number of personal licence issuing authority, if any]
OAKLEIGH ROAD SOUTH, N11 1NP 02083597471

Signed

X 

Name (please print)

SOPHIA HADJI-MICHAEL

Date

18.5.06

APP 2

REPRESENTATION FROM FIRE OFFICER



LONDON FIRE & EMERGENCY PLANNING AUTHORITY

FIRE AND COMMUNITY SAFETY DIRECTORATE
Roy Bishop Deputy Commissioner
Date
23 May 2006Our Ref.
FS/31/011982/LH

Your Ref.

Addressee
Ms D Barrett
Lead Licensing Officer
Haringey Council
2nd Floor, Civic Centre
High Road
Wood Green
London
N22 8LEPlease reply to
Tony Cadman
Inspecting OfficerDirect Telephone
020 8803 7530Direct Fax
020 8807 7196Direct E-mail
haringeygroup@london-fire.gov.uk

Dear Madam,

LICENSING ACT 2003**Premises: The Magic Flute, 31 High Street, London, N8 7QB**

With reference to the application dated 19 May 2006, as shown on plan, number 145,01, the application has been examined and **the Fire Authority want to make a representation** to the Licensing Authority in relation to this application.

The applicant has been informed that the Fire Authority will be making a representation to the Licensing Authority.

The items that are of concern to this authority are detailed on the attached schedule.

Please advise me, at your earliest convenience, of the date and time of the Licensing Committee Hearing.

Should these matters be resolved to the satisfaction of this Authority at least 2 days prior to the Licensing Committee Hearing the representation will be withdrawn.

Any queries regarding this letter should be addressed to the person named at the top of the letter. If you are dissatisfied in any way with the response given, please ask to speak to the Team Leader quoting our reference.

Yours faithfully,

for Assistant Commissioner

Data Protection Act 1998: The information you have given on this form will be processed by London Fire Emergency Planning Authority for the purpose of **fire and emergency planning and control**. We will keep your details secure and will not disclose them to other organisations or third parties (except contractors or suppliers working on our behalf) without your permission unless we are legally required to do so.

For more information about how we use your personal information, see our notification entry (Z7122455) www.informationcommissioner.gov.uk or visit: www.london-fire.gov.uk

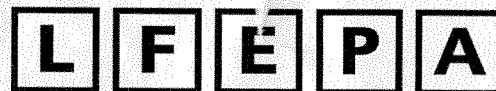

FIRE AND COMMUNITY SAFETY DIRECTORATE

Roy Bishop Deputy Commissioner

The Magic Flute, 31 High Street, London, N8 7QB

Our Ref.
FS/31/011982/LH

Your Ref.

SCHEDULE

Sheet 1 of 1

Schedule referred to in the letter reference FS/31/011982/LH under the Licensing Act 2003, issued by the London Fire and Emergency Planning Authority on 23 May 2006.

Where appropriate, a plan may form part of this Schedule to illustrate the steps which, in the opinion of the fire authority, need to be taken in order to promote the public safety objective.

NOTE : Notwithstanding any consultation undertaken by the fire authority, **before** you make any alterations to the workplace, **you** must apply for local authority building control department approval (and/or the approval of any other bodies having a statutory interest in the premises) if their permission is required for those alterations to be made.

Licensing Objective not adequately addressed	Location and detail of matters which are considered to put people at risk in the event of a fire emergency	Steps considered necessary to promote the public safety licensing objective
Public Safety	Throughout premises	<ol style="list-style-type: none"> 1. Fire alarm to BS5839 Pt6(lights and Buzzers) 2. Emergency Lighting to BS5266 3. Appropriate fire extinguishers suitable for the risk. 4. All signs to comply with BS5499
Public Safety	Throughout Premises	<ol style="list-style-type: none"> 1. Written Fire Risk assessment required 2. Evacuation plan required

Data Protection Act 1998: The information you have given on this form will be processed by London Fire Emergency Planning Authority for the purpose of **fire and emergency planning and control**. We will keep your details secure and will not disclose them to other organisations or third parties (except contractors or suppliers working on our behalf) without your permission unless we are legally required to do so.

For more information about how we use your personal information, see our notification entry (Z7122455) www.informationcommissioner.gov.uk or visit: www.london-fire.gov.uk

APP 3

REPRESENTATION FROM PLANNING

Customer ID 357

Date Received 19 May 2006

Address 1 THE MAGIC FLUTE

Address 2 31 HIGH STREET

Address 3 LONDON

Post Code N8 7QB

Object

Approve

Conditions OBJECTION

REASON FOR OBJECTION IS BASED ON THE FOLLOWING
CONDITION OF CONSENT (HGY/1992/1362) GRANTED ON THE
06/04/1993 FOR THE RETENTION OF GROUND FLOOR FRONT
ROOM AS HOT FOOD TAKEAWAY (A3):

2. The use hereby permitted shall not be operated before 08:00 or
after 18:00 on Mondays to Fridays and not at all on Saturdays,
Sundays, or Bank Holidays.

Reason: This permission is given to facilitate the beneficial use
of the
premises whilst ensuring that the amenities of adjacent
residential
properties are not diminished.

Type of Licence

Notes It would be prudent for the applicant to make a new application
requesting a Variation of Condition requesting the hours of operations
be extended. This formal application would be assessed by the planning
department.

Email Date Sent 24-May-06

This page is intentionally left blank

Licensing Act 2003 Sub-Committee on 4TH JULY 2006

Report title: Application to Vary a Premises Licence for Yayla Restaurant, 429 Green Lanes, London, N4 1HA

Report of: The Lead Officer Licensing

Ward(s) affected Seven Sisters

1. Purpose

To consider an application by **HAYRETTIN KACMAZ** to vary a New Premises Licence

2. Recommendations

- 2.1 (a) Grant the application as asked
 (b) Modify the conditions of the licence, by altering or omitting or adding to them
 (c) Reject the whole or part of the application

The Committee is asked to note that it may not modify the conditions or reject the whole or part of the application unless it is necessary to promote the licensing objectives.

Report authorised by: Robin Payne.....

 Assistant Director Enforcement Services

Contact Officer: Ms Daliah Barrett

Telephone: 020 8489 5103

3. Executive summary

For consideration by Sub Committee under Licensing Act 2003 for a Variation to a New Premises Licence

4. Access to information:

Local Government (Access to Information) Act 1985
 Background Papers

The following Background Papers are used in the preparation of this Report:

File: YAYLA RESTAURANT, 429 GREEN LANES, LONDON, N4 1HA

The Background Papers are located at Enforcement Service, Civic Centre, High Road Wood Green N22

5. REPORT

Background

5.1 Application by **HAYRETTIN KACMAZ**, for a Variation to a New Premises Licence in respect of **YAYLA RESTAURANT, 429 GREEN LANES, LONDON, N4 1HA** under the Licensing Act 2003.

5.2 **Details of Variation to a new Premises Licence application – APP 1**

Opening Hours for Public

Monday to Sunday

08.00 – 02.00

5.2 **Crime and Disorder**

The applicant will take all reasonable steps to ensure that crime and /or disorder does not occur on the premises.

5.4 **Public Safety**

Appropriate fire safety procedures are in place.

5.5 **Public Nuisance**

All customers are asked to respect neighbours and leave quietly. Clear and legible notices will be prominently displayed requesting customers to leave quietly

5.6 **Child Protection**

Restriction under the Licensing act 2003 will apply

If in doubt, the licensee and staff will ask persons who appear to be under age of 18 for photographic ID such as proof of age cards, the connexions card and Citizen Card, photographic driving licence or passport, an official identity card issued by HM Forces or by and EU county, bearing the photograph and date of birth bearer

The applicant is happy to participate in any 'Challenge 21' or 'Think 21' or similar scheme if exits in the area.

6. RELEVANT REPRESENTATIONS (CONSULTATION)

Responsible authorities:

6.1 Comments of Metropolitan Police

The Police have no comments to make.

6.2 Comments of Enforcement Services:

Noise team has made no representation.

Food Team

Have no objections to this application

Health and Safety

Have no objections to this application

Trading Standards

Have no objections to this application

6.3 Fire Officer

The Fire Officer has no objections to this application.

6.4 Planning Officer – App 2

Planning has the following objections to this application.

Reason for objection is based on the following condition of consent (HGY/2000/0612) granted on the 27th February 2000 for a Change of Use of Ground floor from Unit (A1) to (A3) Restaurant.

The use hereby permitted shall not be operated before 8.00 or after 23.30 hours on any day. – This permission is given to facilitate the beneficial use of the premises whilst ensuring that the amenities of adjacent residential properties are not diminished.

And

Permission (Ref. HGY/2005/0064) has been granted as an extension of opening hours on 8th March 2005 for premises to only open from:

09.00 am to 12.00 midnight on Sundays to Thursdays and 10.00 am to 02.00 am on Friday and Saturdays.

6.5 Comments of Child Protection Agency or Nominee

Proof of age scheme to be adhered to

7.0 Interested Parties

2 letters of representation have been received against this application.

App 3

8.0 Financial Comments

The fee which would be applicable for this application was **£190.00**

APP 1

APPLICATION FORM



2005-2006
Getting Closer to Communities



INVESTOR IN PEOPLE

Book 80
 CHA 190
 AG 793000

Application to vary a premises licence under the Licensing Act 2003

PLEASE READ THE FOLLOWING INSTRUCTIONS FIRST

Before completing this form please read the guidance notes at the end of the form.
 If you are completing this form by hand please write legibly in block capitals. In all cases ensure that your answers are inside the boxes and written in black ink. Use additional sheets if necessary.
 You may wish to keep a copy of the completed form for your records.

I/We **HAYRETTIN KACMAZ**
(Insert name(s) of applicant)

being the premises licence holder, apply to vary a premises licence under section 34 of the Licensing Act 2003 for the premises described in Part 1 below

Premises licence number LN/00001598

Part 1 – Premises Details

Postal address of premises or, if none, ordnance survey map reference or description YAYLA RESTAURANT 429 GREEN LANES			
Post town	LONDON	Post code	N4 1HA

Telephone number at premises (if any)	020 8348 9515
Non-domestic rateable value of premises	£12500

Part 2 – Applicant details

Daytime contact telephone number	
E-mail address (optional)	
Current postal address if different from premises address	
Post Town	Postcode

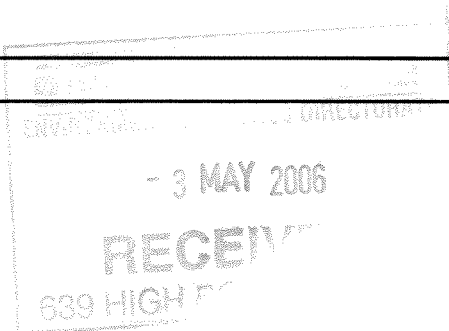

Part 4 Operating Schedule

Please complete those parts of the Operating Schedule below which would be subject to change if this application to vary is successful.

Provision of regulated entertainment**Please tick yes**

- | | |
|--|--------------------------|
| a) plays (if ticking yes, fill in box A) | <input type="checkbox"/> |
| b) films (if ticking yes, fill in box B) | <input type="checkbox"/> |
| c) indoor sporting events (if ticking yes, fill in box C) | <input type="checkbox"/> |
| d) boxing or wrestling entertainment (if ticking yes, fill in box D) | <input type="checkbox"/> |
| e) live music (if ticking yes, fill in box E) | <input type="checkbox"/> |
| f) recorded music (if ticking yes, fill in box F) | <input type="checkbox"/> |
| g) performances of dance (if ticking yes, fill in box G) | <input type="checkbox"/> |
| h) anything of a similar description to that falling within (e), (f) or (g)
(if ticking yes, fill in box H) | <input type="checkbox"/> |

Provision of entertainment facilities:

- | | |
|--|--------------------------|
| i) making music (if ticking yes, fill in box I) | <input type="checkbox"/> |
| j) dancing (if ticking yes, fill in box J) | <input type="checkbox"/> |
| k) entertainment of a similar description to that falling within (i) or (j)
(if ticking yes, fill in box K) | <input type="checkbox"/> |

Provision of late night refreshment (if ticking yes, fill in box L)**Sale by retail of alcohol (if ticking yes, fill in box M)**

In all cases complete boxes N, O and P

B

Films Standard days and timings (please read guidance note 6)			Will the exhibition of films take place indoors or outdoors or both – please tick (please read guidance note 2)	Indoors	<input type="checkbox"/>
				Outdoors	<input type="checkbox"/>
				Both	<input type="checkbox"/>
Day	Start	Finish	Please give further details here (please read guidance note 3)		
Mon					
Tue					
Wed			State any seasonal variations for the exhibition of films (please read guidance note 4) N/A		
Thur					
Fri			Non standard timings. Where you intend to use the premises for the exhibition of films at different times to those listed in the column on the left, please list (please read guidance note 5)		
Sat					
Sun					

D

Boxing or wrestling entertainments Standard days and timings (please read guidance note 6)			Will the boxing or wrestling entertainment take place indoors or outdoors or both – please tick (please read guidance note 2)	Indoors <input checked="" type="checkbox"/>
				Outdoors <input type="checkbox"/>
				Both <input type="checkbox"/>
Day	Start	Finish	Please give further details here (please read guidance note 3)	
Mon				
Tue				
Wed				
Thur			State any seasonal variations for boxing or wrestling entertainment (please read guidance note 4)	
			N/A	
Fri			Non standard timings. Where you intend to use the premises for boxing or wrestling entertainment at different times to those listed in the column on the left, please list (please read guidance note 5)	
Sat				
Sun				

F

Recorded music Standard days and timings (please read guidance note 6)			Will the playing of recorded music take place indoors or outdoors or both – please tick (please read guidance note 2)	Indoors	<input type="checkbox"/>
				Outdoors	<input type="checkbox"/>
				Both	<input type="checkbox"/>
Day	Start	Finish	Please give further details here (please read guidance note 3)		
Mon					
Tue					
Wed			State any seasonal variations for the playing of recorded music (please read guidance note 4)		
Thur					
Fri			Non standard timings. Where you intend to use the premises for the playing of recorded music at different times to those listed in the column on the left, please list (please read guidance note 5)		
Sat					
Sun					

N/A

H

<p>Anything of a similar description to that falling within (e), (f) or (g) Standard days and timings (please read guidance note 6)</p>			<p><u>Please give a description of the type of entertainment you will be providing</u></p>		
Day	Start	Finish	<p><u>Will this entertainment take place indoors or outdoors or both – please tick</u> (please read guidance note 2)</p>	Indoors	<input type="checkbox"/>
Mon				Outdoors	<input type="checkbox"/>
			Both	<input type="checkbox"/>	
Tue			<p><u>Please give further details here</u> (please read guidance note 3)</p>		
Wed					
Thur			<p><u>State any seasonal variations for entertainment of a similar description to that falling within (e), (f) or (g)</u> (please read guidance note 4)</p> <p style="text-align: center;">N/A</p>		
Fri					
Sat			<p><u>Non standard timings. Where you intend to use the premises for the entertainment of a similar description to that falling within (e), (f) or (g) at different times to those listed in the column on the left, please list</u> (please read guidance note 5)</p>		
Sun					

J

Provision of facilities for dancing Standard days and timings (please read guidance note 6)			Will the facilities for dancing be indoors or outdoors or both – please tick (see guidance note 2)	Indoors <input type="checkbox"/>	
				Outdoors <input type="checkbox"/>	
				Both <input type="checkbox"/>	
			<u>Please give a description of the facilities for dancing you will be providing</u>		
Day	Start	Finish	<u>Please give further details here</u> (please read guidance note 3)		
Mon					
Tue					
Wed					
Thur					
Fri					
Sat					
Sun			<u>State any seasonal variations for providing dancing facilities</u> (please read guidance note 4)		
			N/A		
			<u>Non standard timings. Where you intend to use the premises for the provision of facilities for dancing at different times to those listed in the column on the left, please list</u> (please read guidance note 5)		

L

Late night refreshment Standard days and timings (please read guidance note 6)			Will the provision of late night refreshment take place indoors or outdoors or both – please tick (please read guidance note 2)	Indoors	<input checked="" type="checkbox"/>
				Outdoors	<input type="checkbox"/>
				Both	<input type="checkbox"/>
Day	Start	Finish			
Mon	23:00	02:00	Please give further details here (please read guidance note 3)		
Tue	23:00	02:00			
Wed	23:00	02:00	State any seasonal variations for the provision of late night refreshment (please read guidance note 4)		
Thur	23:00	02:00			
Fri	23:00	04:00	Non standard timings. Where you intend to use the premises for the provision of late night refreshment at different times, to those listed in the column on the left, please list (please read guidance note 5)		
Sat	23:00	04:00			
Sun	23:00	02:00			

O

Hours premises are open to the public Standard days and timings (please read guidance note 6)			State any seasonal variations (please read guidance note 4) N/A	
Day	Start	Finish		
Mon	08:00	02:00		
Tue	08:00	02:00		
Wed	08:00	02:00		
Thur	08:00	02:00		Non standard timings. Where you intend the premises to be open to the public at different times from those listed in the column on the left, please list (please read guidance note 5) N/A
Fri	08:00	04:00		
Sat	08:00	04:00		
Sun	08:00	02:00		

Please identify those conditions currently imposed on the licence which you believe could be removed as a consequence of the proposed variation you are seeking
Restriction on operating hours in relation to Fridays and Saturdays only.

P Describe any additional steps you intend to take to promote the four licensing objectives as a result of the proposed variation:

a) General – all four licensing objectives (b,c,d,e) (please read guidance note 9)

The licensee has run the premises for a number of years, and now seeks to vary the premises licence both to enhance his business and continue to provide a local amenity for nearby residents.

The following are proposed as conditions in addition to those already on the existing premises licence.

b) The prevention of crime and disorder

The licensee will report all incidences of a criminal nature that may occur on the premises to the Police.

No less than two members of staff will be on the shop floor of the premises between the hours of 23:00 and 07:00.

c) Public safety

Appropriate fire safety procedures are in place and shall be maintained at all times including fire extinguishers (H₂O, CO₂), illuminated fire exit signs, smoke detectors and emergency lighting.

d) The prevention of public nuisance

The licensee shall display clear and prominent notices requesting customers not to congregate outside the premises.

e) The protection of children from harm

Variation proposes no new risks.





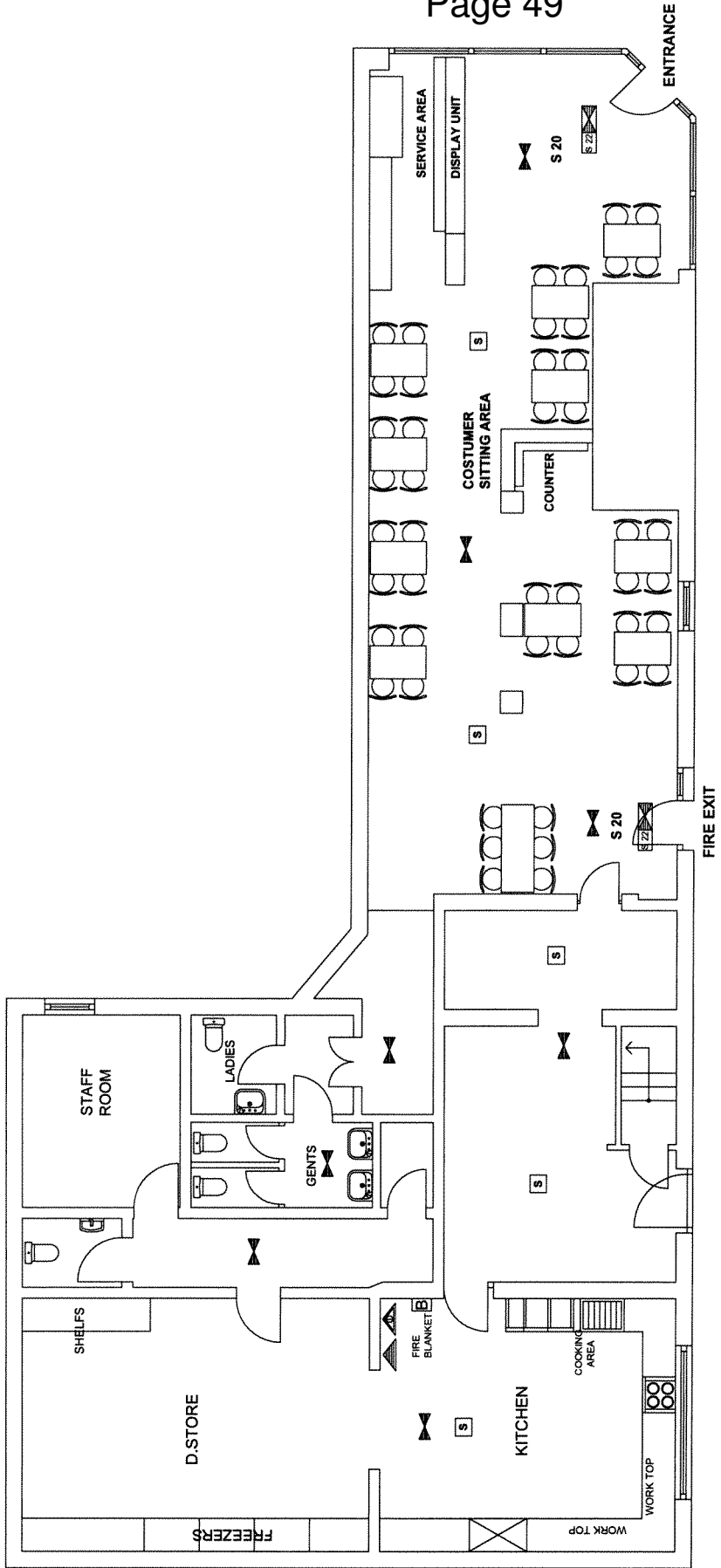

Notes for Guidance

This application cannot be used to vary the licence so as to extend the period for which the licence has effect or to vary substantially the premises to which it relates. If you wish to make that type of change to the premises licence you should make a new premises licence application under section 17 of the Licensing Act 2003.

1. Describe the premises. For example the type of premises, its general situation and layout and any other information which could be relevant to the licensing objectives. Where your application includes off-supplies of alcohol and you intend to provide a place for consumption of these off-supplies you must include a description of where the place will be and its proximity to the premises.
2. Where taking place in a building or other structure please tick as appropriate. Indoors may include a tent.
3. For example state type of activity to be authorised, if not already stated, and give relevant further details, for example (but not exclusively) whether or not music will be amplified or unamplified.
4. For example (but not exclusively), where the activity will occur on additional days during the summer months.
5. For example (but not exclusively), where you wish the activity to go on longer on a particular day e.g. Christmas Eve.
6. Please give timings in 24 hour clock (e.g. 16:00) and only give details for the days of the week when you intend the premises to be used for the activity.
7. If you wish people to be able to consume alcohol on the premises please tick on, if you wish people to be able to purchase alcohol to consume away from the premises please tick off. If you wish people to be able to do both please tick both.
8. Please give information about anything intended to occur at the premises or ancillary to the use of the premises which may give rise to concern in respect of children regardless of whether you intend children to have access to the premises, for example (but not exclusively) nudity or semi-nudity, films for restricted age groups, the presence of gaming machines.
9. Please list here steps you will take to promote all four licensing objectives together.
10. The application form must be signed.
11. An applicant's agent (for example solicitor) may sign the form on their behalf provided that they have actual authority to do so.
12. Where there is more than one applicant, both applicants or their respective agents must sign the application form.
13. This is the address which we shall use to correspond with you about this application.



LEGEND

-  SAFETY LIGHTS
-  SMOKE DETECTOR
-  CARBON DIOXIDE FIRE EXTINGUISHER
-  9 LT. WATER FIRE EXTINGUISHER
-  FIRE ESCAPE KEEP CLEAR
-  INTERNALLY ILLUMINATED FIRE ESCAPE SIGN (BS 5266)

YAYLA RESTAURANT
 429 GREEN LANES
 HARINGEY
 LONDON
 N4 1HA

PROPOSED GROUND FLOOR PLAN

SCALE : 1/100 DATE : 21/07/05
 REF. NO : 4802164-01

276 HIGHBURY
 NEW PARK
 ISLINGTON
 LONDON - N6 2LH
 Tel : 020 7226 3313
www.fsba.org.uk

**PREMISES LICENCE****Receipt:** AG763387**Premises Licence Number:** LN00001598*This Premises Licence has been issued by:*

**The Licensing Authority, London Borough of Haringey,
Civic Centre, High Road, Wood Green,
London, N22 8LE**

Signature:.....**Date:** 24TH November 2005**Part 1 – PREMISES DETAILS**

Postal Address of Premises or, if none, Ordnance Survey map reference or description:

**YAYLA RESTAURANT
429 GREEN LANES
HARINGEY, LONDON
N4 1HA**

Telephone: 020 8348 9515

Where the Licence is time limited, the dates:

N/A

Licensable activities authorised by the Licence:

Provision of Late Night Refreshment

The times the Licence authorises the carrying out of licensable activities:

Monday to Sunday 23.00-02.00

The opening hours of the premises:

Monday to Sunday 08.00-02.00

Where the Licence authorises supplies of alcohol whether these are on and/or off supplies:

No supply of alcohol permitted on this premises.





Part 2

Name, (registered) address, telephone number and e-mail (where relevant) of holder of Premises Licence:

Mr Hayrettin Kacmaz
C/o: YAYLA RESTAURANT
429 GREEN LANES
HARINGEY, LONDON
N4 1HA
Telephone: 020 8348 9515

Registered number of holder, for example company number, charity number (where applicable):

Name, address and telephone number of designated premises supervisor where the Premises Licence authorises the supply of alcohol:

Mr Hayrettin Kacmaz
C/o: YAYLA RESTAURANT
429 GREEN LANES
HARINGEY, LONDON
N4 1HA
Telephone: 020 8348 9515

Personal Licence number and issuing authority of personal licence held by designated premises supervisor where the Premises Licence authorises for the supply of alcohol:

N/A: Designated Premises Supervisor not permitted to sell alcohol.





Annex 1 –Mandatory Conditions





Annex 2 – Conditions consistent with the Operating Schedule

THE PREVENTION OF CRIME AND DISORDER

Customers will be asked to leave the premises quietly and a notice will be displayed accordingly.
Alcohol will not be served on the premises.

PUBLIC SAFETY

Appropriate fire safety procedures will be put in place, including fire extinguishers.
Premises will be suitably and sufficiently lit and maintained in any area accessible to the public.

THE PREVENTION OF PUBLIC NUISANCE

All ventilation and extract systems will be designed and maintained so as to prevent noxious smells causing a nuisance to nearby properties.
Refuse receptacles will be cleaned regularly with disinfectant.
Staff will undertake a regular litter pick up outside the premises.

THE PROTECTION OF CHILDREN

Alcohol will not be served on the premises.





Annex 3 – Conditions attached after a hearing by the licensing authority

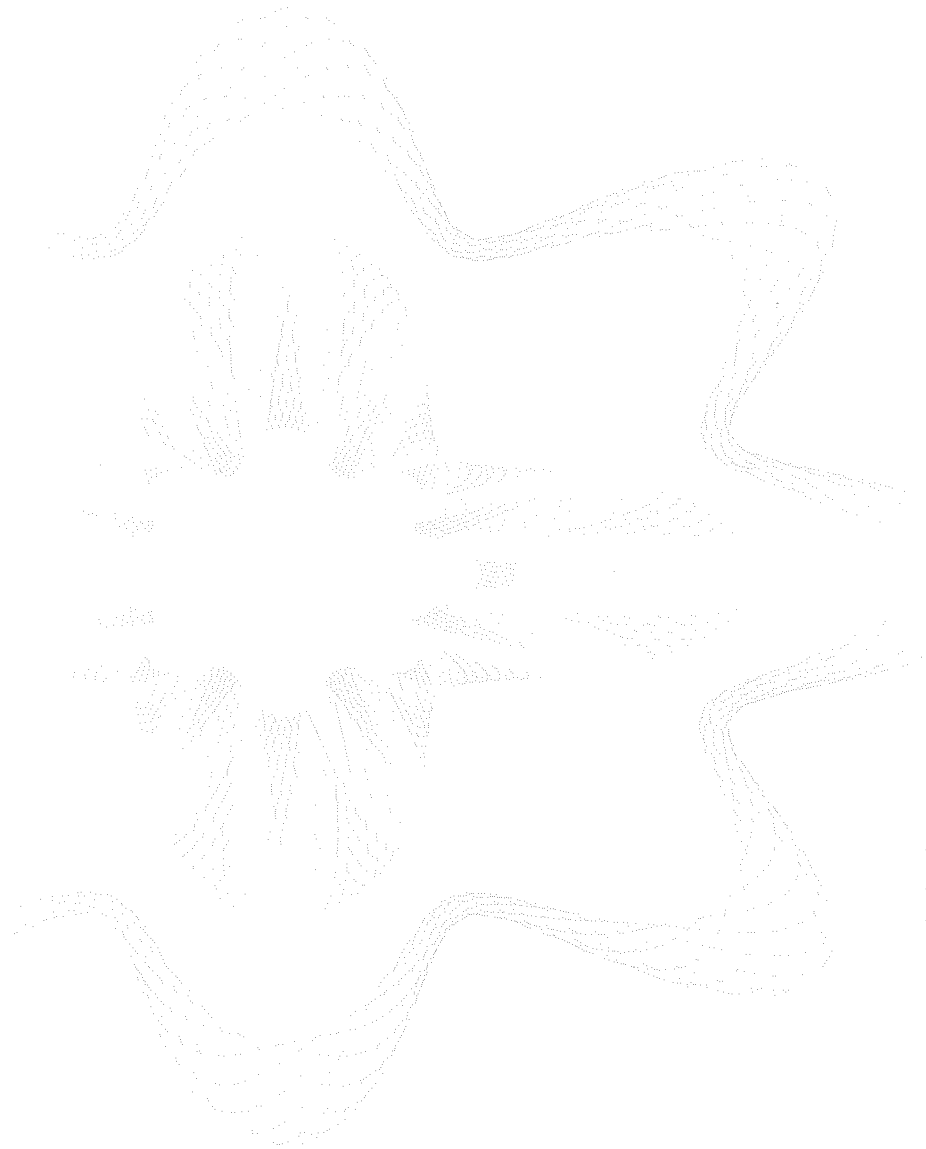



Annex 4 - Plans

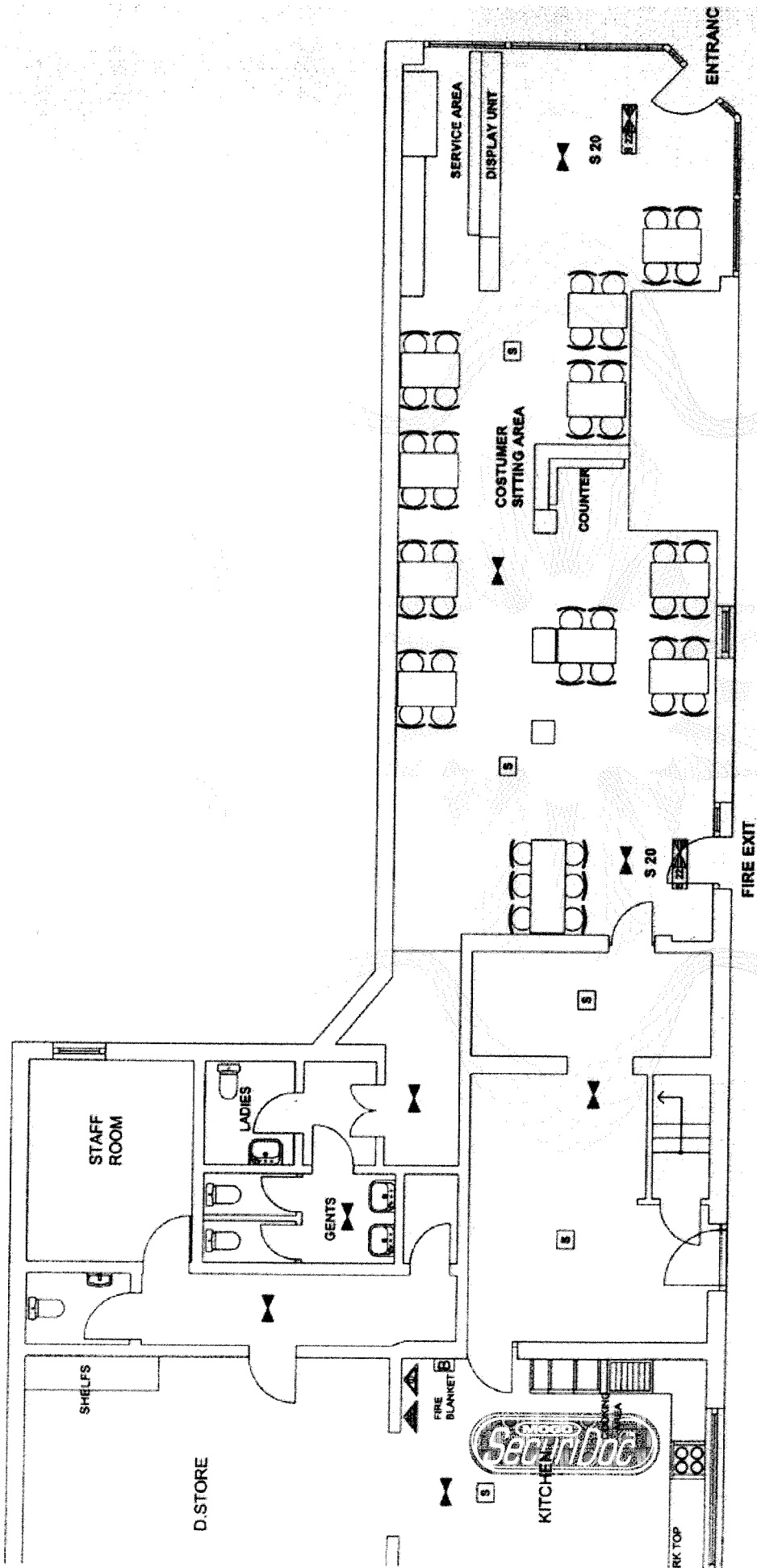

APP 2

PLANNING REPRESENTATION



2005-2006
Getting Closer to Communities



INVESTOR IN PEOPLE

Customer ID 353

Date Received 09 May 2006

Address 1 YAYLA RESTAURANT

Address 2 429 GREEN LANES

Address 3 LONDON

Post Code N4 1HA

Object

Approve

Conditions OBJECTION

REASON FOR OBJECTION IS BASED ON THE FOLLOWING
CONDITION OF CONSENT (HGY/2000/0612) GRANTED ON THE
27/02/2000 FOR A CHANGE OF USE OF GROUND FLOOR FROM
UNIT (A1) TO (A3) RESTAURANT:

2. The use hereby permitted shall not be operated before 8.00 or
after 23:30 hours on any day.

Reason: This permission is given to facilitate the beneficial use
of the premises whilst ensuring that the amenities of adjacent
residential properties are not diminished.

AND:

PERMISSION (REF. HGY/2005/0064) HAS BEEN GRANTED AS AN
EXTENSION OF OPENING HOURS ON 08/03/2005 FOR
PREMISES TO ONLY OPEN FROM:

09:00 AM TO 12:00 MIDNIGHT ON SUNDAYS TO THURSDAYS
AND 10:00 AM TO 02:00 AM ON FRIDAYS AND SATURDAYS.

Type of Licence

Notes

It would be prudent for the applicant to make a new application
requesting a Variation of Condition requesting the hours of operations
be extended.

Email Date Sent 19-May-06

APP 3

RESIDENTS REPRESENTATIONS



2005-2006
Getting Closer to Communities



INVESTOR IN PEOPLE

Received
30/5/06
JB

Karen J Alexander
139 Wightman Road
London N8 0BB
020 8348 5572

30th May 2006

Daliah Barrett
Environmental Control Service
Civic Centre
Wood Green
London
N22 8LE

Dear Ms Barrett

Extension of late night premises licence: Yayla, 429 Green Lanes, London N4 1HA
Applying for extension on Friday and Saturday until 4.00am on the following day as
late night café and take-away

In response to and in support of residents, neighbourhood watch groups and resident's associations concerns, I am writing to you to oppose this application. There are a number of reasons why I feel this application should be refused:-

1. I believe that granting this licence would be against the general principles of Haringey's Licensing Policy and specifically with regard to the prevention of crime and disorder, public safety and the prevention of public nuisance.
2. This premises has repeated applied for and been refused permission for very late hours by the Planning Department on the grounds of loss of amenity to local residents and the surrounding area (including noise, disturbance, parking problems and of course refuse collection). I believe that all these reasons are still very much applicable and that permission should continue to be denied.
3. I believe that increasing the opening hours would lead to more anti-social behaviour and more crime.
4. Longer opening hours is likely to create noise nuisance to local residents and increase in the level of litter.
5. I feel that granting this application would set a precedent and lead to a flood of similar applications which would not be in the interest of the local area.

In conclusion I would urge the Licensing Sub-committee to reject this application and maintain the existing hours of 2am closing for Friday and Saturday nights.

Yours sincerely

A handwritten signature in cursive script that reads "Karen Alexander".

Karen Alexander

LADDER COMMUNITY SAFETY PARTNERSHIP

Incorporating the Are You Sure? campaign.

P.O. Box 32109 London N4 1GN

Telephone: 07931 761 558

...keeping crime off

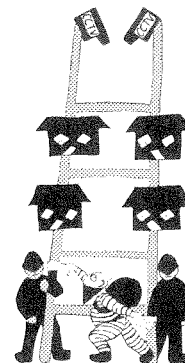

the "Ladder"

Daliah Barrett
Environmental Control Service
Civic Centre
Wood Green
London N22 8LE

25 May 2006

Dear Ms Barrett

**Extension of late-night premises licence: Yayla 429 Green Lanes, N4 1HA
Applying for extension on Friday & Saturday until 4.00 on the following day
as late-night café and take-away**

1 INTRODUCTION

The Ladder Community Safety Partnership (LCSP) contains representatives of Neighbourhood Watches and Residents' Associations from the 'Ladder' roads, adjacent to Green Lanes, Harringay and from Green Lanes itself. We are an independent group, although working in partnership with Haringey Council and the Metropolitan Police where appropriate.

We are writing to you as members of the LCSP to oppose this application.

We believe that in the context of the well known problems in the area, granting a licence for the hours requested would be against the general principles of Haringey's Licencing Policy and specifically under the following headings:

- **The Prevention of Crime and Disorder**
- **Public Safety**
- **Prevention of Public Nuisance**

More information on why we believe the Committee should reject this application is provided under appropriate headings below.

2 PLANNING CONSIDERATIONS

We fully understand that Licensing and Planning are deemed to be two separate but parallel regimes. However it is relevant to note that this premises has repeatedly sought planning permission for very late hours, which has been consistently refused by the Planning service on the grounds of loss of amenity to local residents and the surrounding area (eg noise, local disturbance, parking stress, refuse and rubbish collection etc). It is highly significant that these reasons for refusal under planning law are identical to the criteria for **the prevention of public nuisance** under the new licensing legislation.

Recent Planning history of the premises:

- in 2002, 05.00 daily was refused
- in 2004, 02.00 daily was refused (HGY/2004/1432)
- in 2005, 01.45 (Mon-Sat) and 01.00 (Sun) was refused (HGY/2005/0064)
- finally permission was granted on 8th March 2005 as follows
09.00 -00.00 (Sun-Thurs) and 10.00-02.00 (Fri&Sat) (HGY/2005/0064, amended),
(copy attached)

3 REASONS FOR OBJECTING

(a) Relevant sections of the Borough's Licensing Policy/Objectives

We believe the following statements in the Borough's Licensing Policy support our objections:

- *'the Council considers that licensing law plays a key role in both preventing and controlling ... anti-social behaviour ... by regulating and applying conditions to affect the number, location and hours of premises'* [2.4]
- *'the council will have special regard to the local impact of licensing on related crime and disorder ... particularly when concerning location, impact, operation and management of all proposed licenses, applications, renewals and variations of conditions'* [7.14]
- *'licensed premises, especially those operating late at night and in the early hours of the morning, can cause a wide range of nuisances that can impact on the people living, working or sleeping in the vicinity of the licensed premises. The Council is committed to protecting the residents in the vicinity of these licensed premises.'* [13.1]
- *'in particular, late night activities cause much of this nuisance. Late night cafes ... can have a number of adverse effects on the residents in the vicinity of these premises. Nuisance such as noise, litter, anti-social behaviour, lights and odour all contribute to the loss of amenity to the general public'* [13.2]
- *'the potential for additional crime and disorder and/or public nuisance is increased with longer hours.'* [18.1]
- *'operating hours between 23.00 and 07.00 are considered to give greater potential for*

noise nuisance ' [18.3]

(b) Licensing Hours

In the light of the above statements, we believe that in this case extending the hours until 04.00am on Friday and Saturday nights is totally unreasonable and contrary to the principles of the Borough's Licensing Policy and to the key Licensing Objectives.

We believe that granting of a permanent weekend licence for 20 hour opening is an unreasonable proposition, given the location of the premises in the heart of one of the most densely populated residential areas in the borough.

(c) The Prevention of Crime and Disorder

We have seen the brief comments relating to the prevention of crime and disorder put forward by the applicant. These seem inadequate and residents would also like to highlight the following points:

- has the use of CCTV to prevent crime and disorder been considered?
- are there policies/methods to deal with the arrival of intoxicated patrons and/or persons under the influence of illegal drugs?
- are patrons prevented from drinking alcohol brought onto the premises?
- are there procedures to deal with violence and anti-social behaviour?
- what methods are in place to discourage the handling of stolen goods etc?
- what methods are in place to address prostitution at the premises? (a particular problem on Green Lanes: Met. Police Taskforce 4 reported to the Green Lanes Strategy Group on 8 Sept 2005 that this was currently a serious concern with 5 prostitutes cautioned during the previous week)

(d) Public Safety

We are pleased to note that the applicant states that '*appropriate fire safety procedures are in place, including fire extinguishers*'. However there is a need for greater clarification regarding various aspects of Public Safety as set out in Appendix 2(2) of the Licensing Policy:

- fire safety risk assessment?
- compliance with all relevant building control rules and regulations?
- arrangements for emergency situations, including evacuation?
- arrangement for the management, supervision and training of staff to ensure that these measures are known and implemented?

(e) Prevention of Public Nuisance

We welcome the statements made by the applicant regarding the prevention of public nuisance. However, some further questions remain unanswered, in particular:

- more detail regarding the steps taken, or proposed, to prevent disturbances by customers arriving at, or leaving, the premises? (the Policy states that '*there will be*

greater responsibilities placed on premises operating between 23.00 and 07.00 than at other times of the day')

- the actions necessary to prevent disturbance from deliveries or collections at early or late hours, or staff cleaning up after closing time?
- the steps taken, or proposed, to prevent littering and fouling of public and open spaces - what specific measures are proposed by the business? This is particularly important as the premises also advertises a take-away service
- the arrangement for storage and disposal of trade waste - would the very long hours sought by the applicant lead to increased waste storage and disposal problems?
- the arrangements for cleansing and keeping clean the vicinity of the premises - this will include litter, refuse and other items originating from the premises and fouling caused by customers.

The Borough's Licensing Policy points out the special importance of these issues after 23.00 and in residential areas. (See Appendix 2(3) and 13.2).

3. CONCLUSION

We believe that the above points need to be clarified by the Licensing Committee and clearly specified in any licence granted

Our comments and objections obviously make clear that residents, who are supported by all of our Ward Councillors, are very concerned at the possible implications of a 20 hour licence at weekends for these premises. We would therefore urge the Licensing Sub-committee to reject this application and to maintain the existing hours of 2am closure for Friday and Saturday nights. This is necessary in order to uphold two of the key licensing objectives: the prevention of public nuisance and the prevention of crime and disorder.

Yours sincerely



on behalf of the LCSP

[Approved by the representatives of Neighbourhood Watches and Residents' Associations in the following Roads:]

Representation from Green Lanes and the following Roads:

Umfreville Road	Woollaston Road
Burgoyne Road	Cavendish Road
Pemberton Road	Warham Road
Seymour Road	Hewitt Road
Allison Road	Beresford Road
Effingham Road	Fairfax Road
Falkland Road	Lausanne Road
Hampden Road	Sydney Road

Environmental Services Directorate

Planning and Environmental Control Service

639 High Road, Tottenham, London, N17 8BD **Your ref:**

Tel: 020 8489 0000

Fax: 020 8489 5220

Minicom: 020 8489 5549

Date: 16/03/05

Our ref: HGY/2005/0064

Contact: Elizabeth Ennin-Gyasi

Telephone: 020 84895126

Ladder Community Safety Partnership
PO Box 32109
LONDON
N4 1GN

Dear Sir/Madam

Town and Country Planning Act 1990

Town and Country Planning (General Development Procedure) Order 1995

Location: 429 - 429A Green Lanes N4

Proposal: Extension of opening hours from 08:00am - 23:30pm Sunday to Thursday to 09:00am to 12:00 midnight Sunday to Thursday and Friday to Saturday from 08:00am - 23:30pm to 10:00am to 02:00am.

With reference to the above planning application I am writing to inform you that after taking into consideration relevant planning policies and the comments of local residents the Council has on 08/03/2005, GRANTED planning permission subject to the following condition:

1. A suitable soundproofing scheme to provide effective resistance to the transmission of airborne and impact sound shall be submitted to, approved in writing by, and implemented in accordance with the requirements of the Local Planning Authority for all compartment floors and party walls prior to the operation of the approved extension of hours.

Reason: In order to ensure that the proposed conversion does not give rise to an unacceptable loss of amenity for occupiers within the property as a direct result of inadequate soundproofing.

REASONS FOR APPROVAL

It is considered that the extension of hours proposed in relation to this application is reasonable and should not unduly affect the amenities of the locality or the existing occupiers. Accordingly it is considered to comply with the following policies STC 2.4 'A3 Uses Food and Drink', DES 1.9 'Privacy and amenity of neighbours' and RIM 3.3 'Nuisance from existing uses and road traffic'. The application is therefore recommended for approval.

Thank you for showing an interest in this matter.

Yours faithfully



Paul Smith
Head of Development Control East

DIRECTOR Peter Norton
ASSISTANT DIRECTOR - PLANNING, ENVIRONMENTAL POLICY & PERFORMANCE Shifa Mustafa

DECGE
Informing of decision
East Team

This page is intentionally left blank